

# RgoSling/ EvoSling/ Nova Stand Up

## Periodic Inspection



According to ISO:10535 2006 Annex B

PI40001 Rev B 2015-04-21

### Scope

Periodic inspection must be carried out at least every 6 months. More regular inspection may be required if the sling is used or washed more often than is normal. Inspection shall be performed by trained personell. Use this checklist to find signs of damage, wear or potential failure. Verify that the sling is safe to use until next periodic inspection. Inspection record should retained safely for examination in case of an accident.



Destroy and discard damaged and old slings that does not pass inspection.

### Prouct Information (use list if more then one):

**Sling Model:**  
(Ex. Nova Stand Up) .....

**Art.No:** .....

**Size:**  XXS  XS  S  M  
 L  XL  XXL

**Serial no.:** .....

### Checklist

OK	Failure	N/A	
<input type="checkbox"/>	<input type="checkbox"/>		<b>1. Product label</b> It is possible to read; Maxload (SWL), Article no., Serial number, Size, Washing symbols.
<input type="checkbox"/>	<input type="checkbox"/>		<b>2. Fabric</b> No tears or frays, burnmarks, holes, color variations, bad smell or other signs of wear.
<input type="checkbox"/>	<input type="checkbox"/>	<input type="checkbox"/>	<b>3. Padding</b> No shrinkage, bulks, bolds or folds.
<input type="checkbox"/>	<input type="checkbox"/>		<b>4. Seams</b> No loose threads, or damaged seams/stiches.
<input type="checkbox"/>	<input type="checkbox"/>	<input type="checkbox"/>	<b>5. Lifting Straps and edge band</b> No tears or frays, stretchmarks, burnmarks or other signs of wear.
<input type="checkbox"/>	<input type="checkbox"/>	<input type="checkbox"/>	<b>6. Guide handles and pockets</b> No tear, frays or loose stitches.
<input type="checkbox"/>	<input type="checkbox"/>	<input type="checkbox"/>	<b>7. Details</b> Ladderlocks, buckles or rings have no damage or cracks
<input type="checkbox"/>	<input type="checkbox"/>		<b>8. User manual</b> User manual is available (User manuals can be downloaded from <a href="http://www.etac.com">www.etac.com</a> )

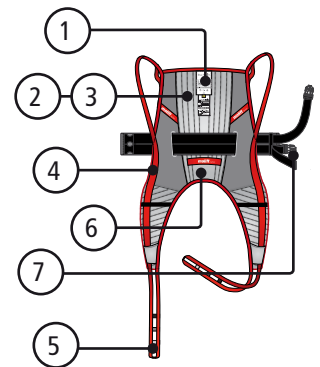

### Approved by:

Check all 8 points in checklist. If one or more of the points has a failure, the sling is not approved for use.

**Date:** .....

**Name of inspector:**  
(Capital letters) .....

**Signature** .....

Use permanent marker or hole punch to mark sling label with date of performed inspection. Next inspection is due within 6 months from this date.

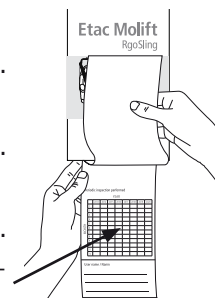

Etac AS,  
Etac Supply Gjøvik  
Hadelandsveien 2,  
2816 Gjøvik, Norway  
Tel +47 4000 1004  
[molift@etac.com](mailto:molift@etac.com) [www.etac.com](http://www.etac.com)

